

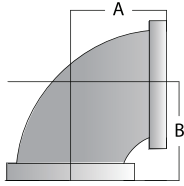

**Notice:** D.I. Fittings have higher tensile strength than that of steel pipe, over tightening can cause damage to pipe threads which may cause leakage. D.I. Fitting should be tightened three turns beyond hand tighten, no more than four turns.

D.I. Threaded fittings are UL, cUL listed and Factory Mutual approved for 500psi service. D.I. Per ASTM A 536 grade 65-45-12. Dimensions conform to ANSI B16.3 Class 150. Threads are NPT per ANSI/ASME B1.20.1

## D.I. 90 Degree Elbow



NOM SIZE	DIMENSION		ITEM WEIGHT
	A	B	
1"	1.50	1.50	0.62
1 1/4"	1.75	1.75	0.90
1 1/2"	1.94	1.94	1.20
2"	2.25	2.25	1.85

## D.I. Red. 90 Deg. Elbow

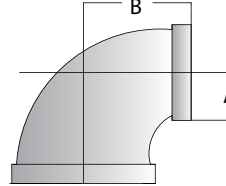

NOM SIZE	DIMENSION		ITEM WEIGHT
	A	B	
1 X 1/2"	1.26	1.36	0.44
1 X 3/4"	1.37	1.45	0.52
1 1/4 X 1/2"	1.34	1.53	0.64
1 1/4 X 3/4"	1.45	1.62	0.72
1 1/4" X 1"	1.58	1.67	0.75
1 1/2" X 1"	1.65	1.80	0.92
1 1/2" X 1 1/4"	1.82	1.88	1.08
2" X 1/2"	1.49	1.88	1.08
2" X 3/4"	1.60	1.97	1.24
2" X 1"	1.73	2.02	1.40
2" X 1 1/4"	1.90	2.10	1.52
2" X 1 1/2"	2.02	2.16	1.65

## D.I. Straight Tee

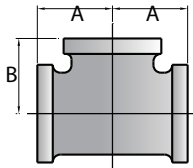

NOM SIZE	DIMENSION		ITEM WEIGHT
	A	B	
1"	1.50	1.50	0.85
1 1/4"	1.75	1.75	1.22
1 1/2"	1.94	1.94	1.55
2"	2.25	2.25	2.45

## D.I. Reducing Coupling

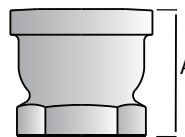

NOM SIZE	DIM.	ITEM WEIGHT
	A	
1 X 1/2"	1.69	0.39
1 X 3/4"	1.69	0.53

## D.I. Coupling

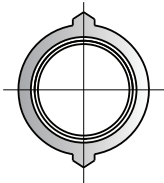
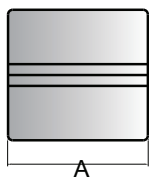

NOM SIZE	DIM.	ITEM WEIGHT
	A	
1"	1.50	0.85
1 1/4"	1.75	1.22
1 1/2"	1.94	1.55
2"	2.25	2.45

## D.I. 45 Degree Elbow

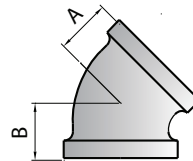

NOM SIZE	DIMENSION		ITEM WEIGHT
	A	B	
1"	1.12	1.12	0.46
1 1/4"	1.29	1.29	0.73
1 1/2"	1.43	1.43	0.92
2"	1.68	1.68	1.50



## D.I. Bushing

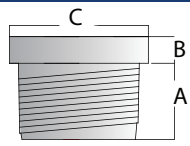

OUTSIDE HEAD

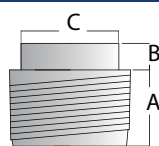

INSIDE HEAD



NOM SIZE	DIMENSION			STYLE	ITEM WT.
	A	B	C		
1 X 1/2"	0.75	0.25	1.42	OUT	0.22
1 X 3/4"	0.75	0.25	1.42	OUT	0.17
1 1/4" X 1"	0.80	0.28	1.76	OUT	1.28
1 1/2" X 1"	0.83	0.31	2.00	OUT	0.44
1 1/2" X 1 1/4"	0.83	0.31	2.00	OUT	0.30
2" X 1"	0.88	0.41	1.95	IN	0.66
2" X 1 1/4"	0.88	0.34	2.48	OUT	0.72
2" X 1 1/2"	0.88	0.34	2.48	OUT	0.61

## D.I. Cross

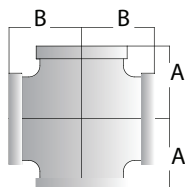

NOM SIZE	DIMENSION		ITEM WEIGHT
	A	B	
1"	1.50	1.50	0.98
1 1/4"	1.75	1.75	1.50
1 1/2"	1.94	1.94	1.90
2"	2.25	2.25	2.95
1 1/4" X 1"	1.58	1.67	1.27
1 1/2" X 1"	1.65	1.80	1.45
2" X 1"	1.73	2.02	2.10

## D.I. Cap



NOM SIZE	DIM.	ITEM WEIGHT
	A	
1"	1.16	0.32
1 1/4"	1.28	0.43
1 1/2"	1.33	0.60
2"	1.45	0.91

## D.I. Reducing Tee

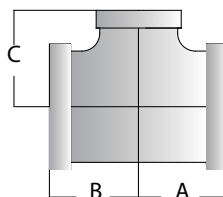

NOM SIZE	DIMENSION			ITEM WEIGHT
	A	B	C	
1" x 1" x 1/2"	1.26	1.26	1.36	0.64
1" x 1" x 3/4"	1.37	1.37	1.45	0.73
1" x 1/2" x 1"	1.50	1.36	1.50	0.71
1" x 3/4" x 1"	1.50	1.45	1.50	0.76
1" x 1" x 1 1/4"	1.67	1.67	1.58	0.98
1" x 1" x 1 1/2"	1.80	1.80	1.65	1.16
1 1/4" x 1" x 1/2"	1.34	1.26	1.53	0.82
1 1/4" x 1" x 3/4"	1.45	1.37	1.62	0.90
1 1/4" x 1" x 1"	1.58	1.50	1.67	1.00
1 1/4" x 1" x 1 1/4"	1.75	1.67	1.75	1.08
1 1/4" x 1" x 1 1/2"	1.88	1.88	1.82	1.42
1 1/4" x 1 1/4" x 1/2"	1.34	1.34	1.53	0.86
1 1/4" x 1 1/4" x 3/4"	1.45	1.45	1.62	0.92
1 1/4" x 1 1/4" x 1"	1.58	1.58	1.67	0.95
1 1/4" x 1 1/4" x 1"	1.88	1.88	1.82	1.45
1 1/4" x 1 1/4" x 2"	2.10	2.10	1.90	1.75
1 1/2" x 1" x 1/2"	1.41	1.34	1.66	0.95
1 1/2" x 1" x 3/4"	1.52	1.37	1.75	1.14
1 1/2" x 1" x 1"	1.65	1.50	1.80	1.17
1 1/2" x 1" x 1 1/4"	1.82	1.67	1.88	1.34
1 1/2" x 1" x 1 1/2"	1.94	1.80	1.94	1.45
1 1/2" x 1 1/4" x 1/2"	1.41	1.34	1.66	1.05
1 1/2" x 1 1/4" x 3/4"	1.52	1.45	1.75	1.15
1 1/2" x 1 1/4" x 1"	1.65	1.58	1.80	1.25
1 1/2" x 1 1/4" x 2"	2.16	2.10	2.02	1.90
1 1/2" x 1 1/2" x 1/2"	1.41	1.41	1.16	1.15
1 1/2" x 1 1/2" x 3/4"	1.52	1.52	1.75	1.24
1 1/2" x 1 1/2" x 1"	1.65	1.65	1.80	1.30
1 1/2" x 1 1/2" x 1"	1.82	1.82	1.88	1.48
1 1/2" x 1 1/2" x 2"	2.16	2.16	2.02	1.98
2" x 1" x 2"	2.25	2.02	2.25	2.15
2" x 1 1/4" x 2"	2.25	2.10	2.25	2.30
2" x 1 1/2" x 1/2"	1.49	1.41	1.88	1.50
2" x 1 1/2" x 3/4"	1.60	1.52	1.97	1.62
2" x 1 1/2" x 1"	1.73	1.65	2.02	1.64
2" x 1 1/2" x 1 1/4"	1.90	1.82	2.10	1.80
2" x 1 1/2" x 1 1/2"	2.02	1.94	2.16	2.00
2" x 1 1/2" x 2"	2.25	2.16	2.25	2.35
2" x 2" x 1/2"	1.49	1.49	1.88	1.60
2" x 2" x 3/4"	1.60	1.60	1.97	1.68
2" x 2" x 1"	1.73	1.73	2.02	1.85
2" x 2" x 1 1/4"	1.90	1.90	2.10	2.04
2" x 2" x 1 1/2"	2.02	2.02	2.16	2.18
2" x 2" x 2 1/2"	2.60	2.60	2.39	3.61
2 1/2" x 2" x 3/4"	1.74	1.60	2.32	2.28